

Product Highlights

- The RL113 High Intensity Bright Field ring light offers a very wide array of wavelengths from UV to IR.

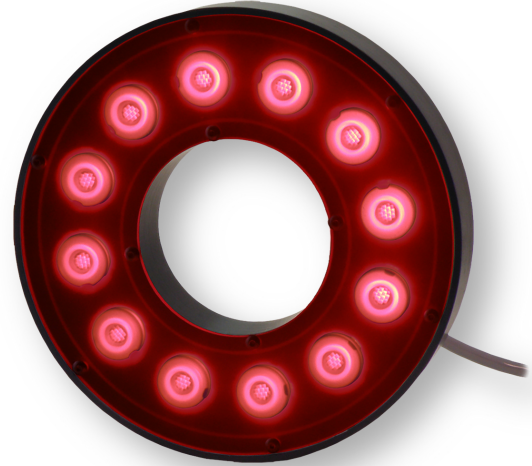

General Specifications

| | | | |
|------------------------------|-----------------------------------------------------------------------------|-------------|--------------------|
| Electrical Specifications | Color | 24V Current | All Other Controls |
| | 365, 375, 385, 395, 405 | 0.54 A | 0.90 A Max |
| | 590, 625, 660, 730 | 0.51 A | 0.64 A Max |
| | 455, 470, 505, 530, WHI | 0.54 A | 0.81 A Max |
| | 850, 940 | 0.51 A | 0.80 A Max |
| Normal Operating Temperature | 0 - 60°C | | |
| Weight | 725.7g (25.60z) | | |
| Standard Cable Information | Up to 2 meters (80") long - 105°C rated PVC jacket, foil shield with drain | | |
| Photobiological Risk Factor | Exempt Applicable Wavelengths: 850, 940 Line 1.5 Line 2 Line 2 Line 2 | | |
| Compliance | CE, RoHS, IEC 6247 | | |
| IP Rating | IP67 | | |
| Lumen Maintenance | L70 = 50,000 Hours | | |

Part Number Key

| Model | Lens Option ⁴ | — | Spectral Wavelength | Connector/Control | — | Alternative Connector |
|---------------------------------------------------|---------------------------------------------------------------------------------------|----------------------------------------------------------------------------------------------------------|-------------------------------------------------------------------------------------------------------------------------------------------------------------------------------------------------------------------------------------------------------------------------------|------------------------------------------------------------------------------|----------|-----------------------|
| RL113 | | — | XXX | XX | — | XXX |
| RL113 | M (medium) W (wide) <small>(narrow lens comes standard when left blank)</small> | | (UV) 365 (UV) 375 (UV) 385 (UV) 395 (violet) 405 (royal blue) 455 (blue) 470 (cyan) 505 (green) 530 (amber) 590 ² (red orange) 625 ² (red) 660 (infra-red) 730 (infra-red) 850 (infra-red) 940 (white) WHI | C1 C5 IC I3 I3S 24 | | M12 ¹ |
| Ex: RL113M-470C5 RL113-625I3-M12 | | ¹ Available with IC, I3, I3S and 24 options only ² Not available with 24 option | | ⁴ Beam angle (FWHM): narrow = 8° medium = 21° wide = 29° | | |

Stock Product: *shipped within 3 days* **Build to Order:** *shipped within 2 weeks*
RL113-WHIIC

Electrical Specs

ICS 2 (IC)

| Pin (M12) | Function | Wire Color |
|-----------|-------------------------|------------|
| 1 | +24 VDC | Brown |
| 2 | 0-10 VDC Analog Control | White |
| 3 | GND | Blue |
| 4 | GLO | Black |
| 5 | N/A | Gray |

ICS 3 (I3 and I3S)

| Pin (M12) | Function | Wire Color |
|-----------|-------------------------|------------|
| 1 | +24 VDC | Brown |
| 2 | GND | White |
| 3 | GND | Blue |
| 4 | PNP/Active High Trigger | Black |
| 5 | 0-10 VDC Analog Control | Gray |

24 Volt

| Pin (M12) | Function | Wire Color |
|-----------|----------|------------|
| 1 | +24 VDC | Brown |
| 2 | N/A | White |
| 3 | -24 VDC | Blue |
| 4 | N/A | Black |
| 5 | N/A | Gray |

Optional M12 Pinout

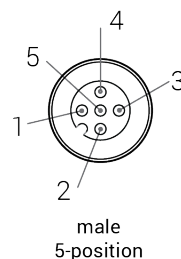

Intensity Distribution

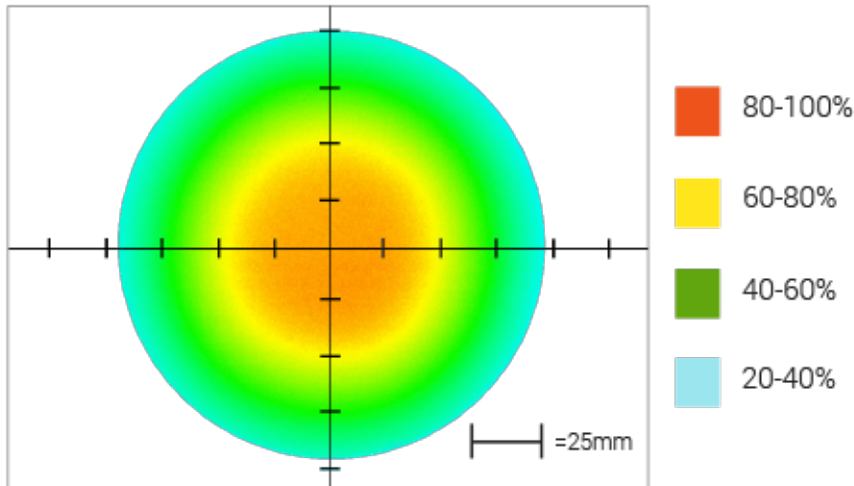

Optical measurement taken using RL113-WHIC @ 300 mm

Area of Illuminance & Intensity

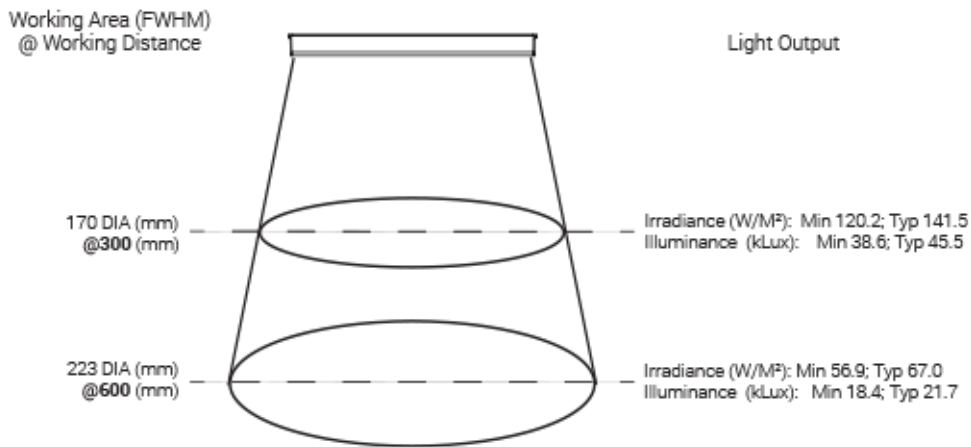

Mechanical Specs

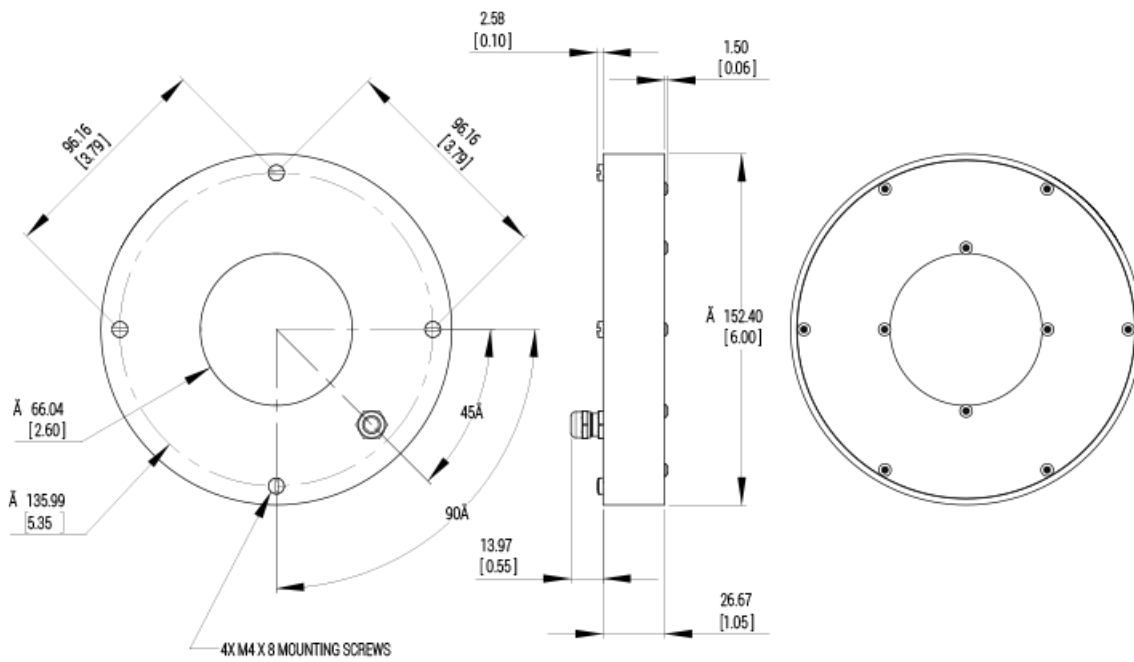

DIMENSIONS ARE IN MILLIMETERS [INCHES]

Control Specs

| C1 Connector | C5 Connector | ICS 2 (I2) | ICS 3 (I3) | ICS 3S (I3S) | 24 |
|----------------------------------------------------|-----------------------------------------------------------|----------------------------------------------------------------------------------|--------------------------------------------------------------------------------------------------------|--------------------------------------------------------------------------------------------------------|----------------------------------------------------------------------|
| For use with: DCS Series Controllers | For use with: Pulsar 320 Strobe Controller. | Continous in-line controller <i>Powered with: 24V power supply</i> | Combination strobe/continous in-line controller <i>Powered with: 24V power supply</i> | Default-OFF strobe/continous in-line controller <i>Powered with: 24V power supply</i> | Flying/tinned leads <i>Powered with: 24V power supply</i> |

Warranty Information

Every Advanced illumination, Inc. (Ai) product is thoroughly inspected and tested before leaving the factory. Products are warranted to be free of defects in workmanship and materials for a period of FIVE YEARS from the original date of purchase. Should a defect develop during this period, customers may return the complete product, freight prepaid, to one of Ai's distributors or to the Ai factory. All product warranty returns require a Return Merchandise Authorization (RMA) number which is obtained from Customer Service. The RMA number must be clearly marked on the outside of the package. Ai will inspect the unit, and if a defect is found will, at our option, repair or replace the product without charge. Ai disclaims liability for any implied warranties, including implied warranties of "merchantability" and "fitness for a specific purpose." For products under warranty that have since been discontinued, Ai will make an effort to replace with equivalent parts; for circumstances that do not allow for equivalent replacement, Ai reserves the right to repair or replace these products with an updated version. Ai cannot be held responsible for the unauthorized or inappropriate use of its products. Any unauthorized repair or modifications will result in a voided warranty.

No Liability for Consequential Damages: In no event shall Ai be liable for any consequential, special, incidental, or indirect damages of any kind arising from the sale or use of the products.

Electromagnetic Compatibility

This product was tested and complies with the regulatory requirements and limits for electromagnetic compatibility (EMC) as stated in the product specifications. These requirements and limits are designed to provide reasonable protection against harmful interference only when the product is operated in its intended industrial electromagnetic environment. To minimize the potential for electromagnetic interference or unacceptable performance degradation, install and use this product in strict accordance with the instructions in the product documentation.

Customer Service

For information on existing orders, or to make an order adjustment, contact us Monday through Friday 8:00 am to 5:00 pm ET or send an email to orders@advill.com.

Company Information

Advanced Illumination

440 State Garage Road, Rochester, VT 05767

Phone: 802.767.3830

Fax: 802.767.3831

Email: info@advancedillumination.com

Web: advancedillumination.com

© 2020 Advanced illumination Inc. All rights reserved